

The Hinton Series

BLRH - Recessed Hospital-Grade

Project	Date
<input type="text"/>	<input type="text"/>
Part	Type
<input type="text"/>	<input type="text"/>

About The Hinton Series

The BLRH is a luminaire designed for use in Hospitals where energy-efficiency, performance and ease of maintenance is essential. This solution is designed with the patient and medical professional in mind, offering ambient, exam, reading, and nightlight settings with colour temperature options for all configurations to ensure patient comfort.

Specifications

Supported Voltage	120-277V, 347V, 120-347V
Available Sizes	1x4', 2x2', 2x4'
Lifetime	L70 of 100,000+ hours
Lumens	Ambient 1.5L-4.5L, Exam 3.5L-15L
Operating Temperature	-20°C/+25°C (-40°/+40°C upgrade)
CCT	2700K, 3000K, 3500K, 4000K, 5000K, 6500K
CRI	80+ standard, 90+ and 95+ available
Dimming	0-10V Standard
Mounting	Designed for T-Bar ceilings

Approvals

- Made with UL Listed components

The Hinton Series

BLRH - Recessed Hospital-Grade

Hospital Grade Lighting
by

BJTAKE
LIGHTING

Ordering Information

	Size		Exam Light		Nightlight	
BLRH	- 24	- A4L835	- E12L835	- R835	- N835	- UN3
Fixture Series		Ambient Light		Reading Light		Voltage

1	2		3	4		5		6	
BLRH									
Series		Size		Ambient Lm		Ambient CRI		Ambient CCT	
BLRH		14	1x4	1x4-A1.5L		8	80	27	2700K
		22	2x2	2x2-A2L		9	90+	30	3000K
		24	2x4	2x2-A2.5L		1	95+	35	3500K
				2x2-A3L				40	4000K
				2x4-A3L				50	5000K
				2x4-A3.5L				65	6500K
				2x4-A4L					
				2x4-A4.5L					

Options

Lenses

BLANK Frosted Acrylic

Dimming

B11 0-10V Dimming Leads
B12 Line voltage dimming
B27 Dim-to-off Driver
B** Other Options Available*

Emergency Driver

B17 UL924 10W Battery Back-up on Ambient Light
F8 UL924 Emergency Relay

Finish

BLANK Standard Matte White
C5 Matte Black
CUSTOM* Custom Colour Choice

Packaging

BLANK Individually Boxed on Pallets
P0 Bulk Packaging

Warranty



CL7 10-Year Comprehensive Warranty Upgrade

Certifications and Listings

Certifications that apply to this fixture and its possible configurations are listed here. More information available upon request.

Usage Applications

This fixture can be used in a variety of applications, and is ideal for the following:

Icon	Description
	Wireless Controls Available
	90 and 95+ CRI Options Available
	120-347V(UN3) Available

Usage Application
Hospitals
Long-Term Care

Warranty Statement

BJ Take products are tested and/or inspected prior to being packaged for shipment and are guaranteed from the day the product is shipped for a period of ten-year LED chip warranty and a five-year comprehensive component warranty. This can be upgraded to a ten-year comprehensive warranty on request.

Light Configuration Diagrams

The BLRH has settings depending on the style of lighting required by the patient. Please refer to the diagram below for setting information.

Off	Reading	Ambient	Exam	NightLight	On
-----	---------	---------	------	------------	----

The Hinton Series

BLRH - Recessed Hospital-Grade

Hospital Grade Lighting
by

BJTAKE
LIGHTING

BLRH 1x4 Side Dimensions

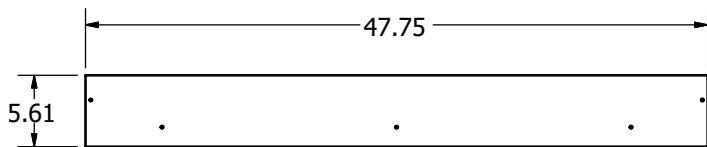

1x4 End Dimensions

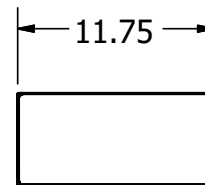

BLRH 2x2 Side Dimensions

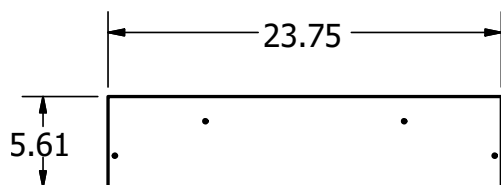

2x2 End Dimensions

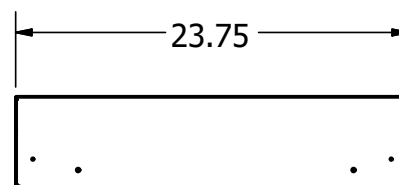

BLRH 2x4 Side Dimensions

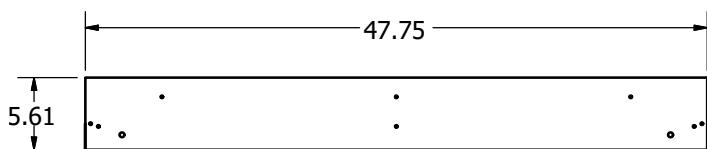

2x4 End Dimensions

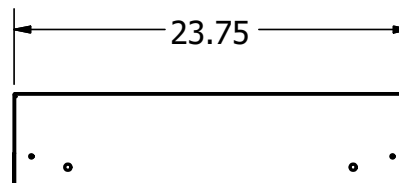

BLRH Ambient Light Wattage

Output	Current Lumens	lm/W	wattage
3.5L	3549	128.1	27.70
4.5L	4529	126.3	35.86

BLRH Exam Light Wattage

Output	Current Lumens	lm/W	wattage
10L	10183	149.90	67.93
12L	12125	149.89	80.89

BLRH NightLight Wattage

Output	Current Lumens	lm/W	wattage
0.4L	444	98.1	4.53

BLRH Reading Light Wattage

Output	Current Lumens	lm/W	wattage
1L	1010	84	12.02

* Drawings aren't to scale

* Standard tolerances apply

* Specifications may change without notice

The Hinton Series

BLRH - Recessed Hospital-Grade

Hospital Grade Lighting
by

BJTAKE
LIGHTING

BLRH-2X4-10L-E840-L18

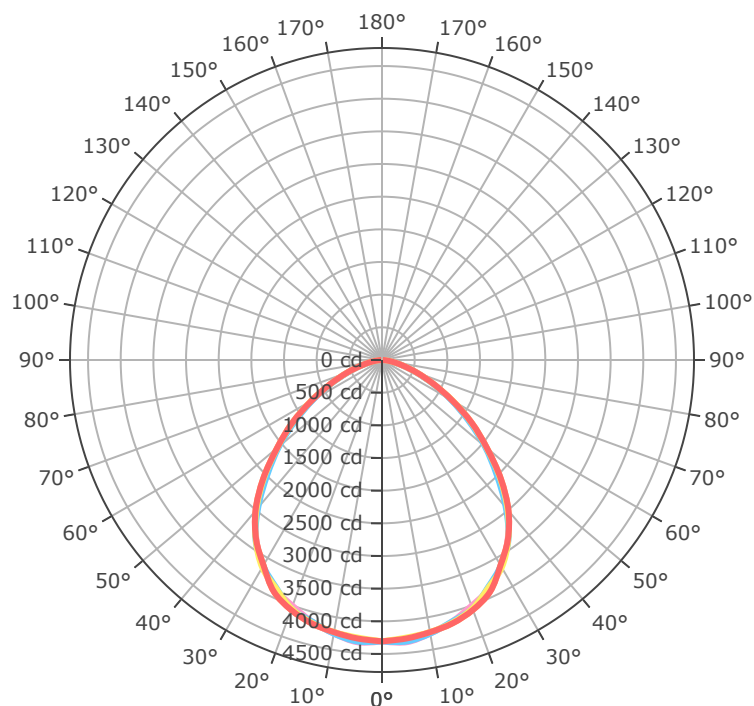

- 0.0°
- 45.0°
- 90.0°
- 135.0°
- 180.0°

Mtg Height	Light Level	Beam Diameter
6.0 ft	119.6 fc	14.0 ft
8.0 ft	67.3 fc	18.7 ft
10.0 ft	43.1 fc	23.3 ft
12.0 ft	29.9 fc	28.0 ft
14.0 ft	22.0 fc	32.7 ft
16.0 ft	16.8 fc	37.4 ft
24.0 ft	7.5 fc	56.0 ft
32.0 ft	4.2 fc	74.7 ft
40.0 ft	2.7 fc	93.4 ft
48.0 ft	1.9 fc	112.1 ft
56.0 ft	1.4 fc	130.8 ft
64.0 ft	1.1 fc	149.4 ft

BLRH-2X4-4.5L-A840-L18

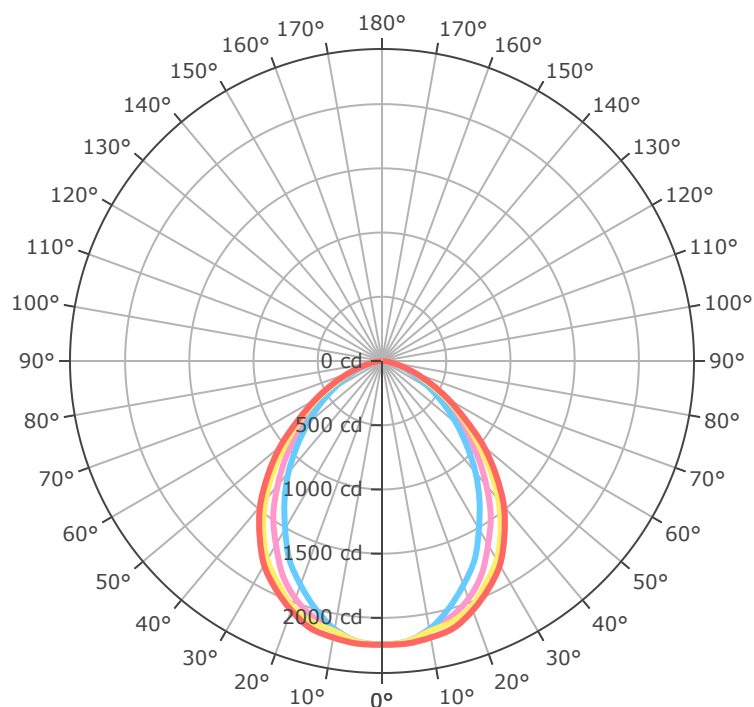

- 0.0°
- 45.0°
- 90.0°
- 135.0°
- 180.0°

Mtg Height	Light Level	Beam Diameter
6.0 ft	61.3 fc	13.5 ft
8.0 ft	34.5 fc	18.0 ft
10.0 ft	22.1 fc	22.5 ft
12.0 ft	15.3 fc	27.0 ft
14.0 ft	11.3 fc	31.5 ft
16.0 ft	8.6 fc	36.0 ft
24.0 ft	3.8 fc	54.0 ft
32.0 ft	2.2 fc	72.0 ft
40.0 ft	1.4 fc	90.0 ft
48.0 ft	1.0 fc	108.1 ft
56.0 ft	0.7 fc	126.1 ft
64.0 ft	0.5 fc	144.1 ft

The Hinton Series

BLRH - Recessed Hospital-Grade

Hospital Grade Lighting
by

BJTAKE
LIGHTING

Gallery Information

Below you will find images of relevant products and configurations for the BLRH.

